

Product Data Sheet

DIN 41612 Male 90°, type G,
Part No. 111-40264

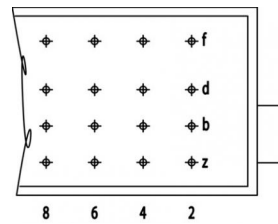
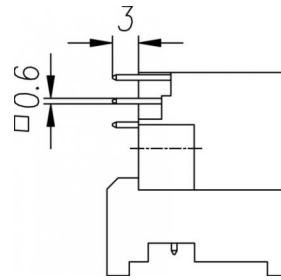
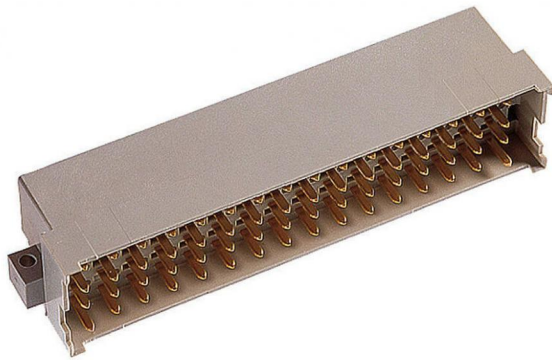

Illustration similar



Perpendicular



Through Hole



Power



Rugged

- Termination length 3 mm
- 64 contacts
- pre-mating contact at pos. Z2 & Z32
- solder
- performance level 2



» to product on www.ept.de



» to product group DIN 41612

Product Data Sheet

DIN 41612 Male 90°, type G,
Part No. 111-40264



Technical Specifications

Basics

| | |
|-----------------------------|-------------------------|
| Specification | IEC 60603-2 (DIN 41612) |
| Performance Level | 2 |
| No. of Contacts | 64 |
| Termination Technology | solder |
| Termination Length | 3 mm |
| Operating Temperature Range | -55°C to +125°C |

Material

| | |
|--------------------|---------------------------|
| Insulator Material | PC glass filled UL 94 V-2 |
| Contact Material | Copper alloy |

Mechanical

| | |
|--------------------------|-------------------|
| Pitch | 5.08 x 3.81 mm |
| Mating Force | < 100 N |
| Separating Force per Pin | >0.2 N |
| Durability | 400 mating cycles |

Electrical

| | |
|------------------------|----------------------------|
| Operational Current | 5.6 A |
| Contact Resistance | <15 mΩ |
| Clearance and Creepage | cr: ≥ 3.0 mm, cl: ≥ 1.6 mm |
| Insulation Resistance | >10 ⁶ MΩ |
| Test Voltage | 1550 V |

Approval / Compliance

| | |
|-------------|----------------|
| UL file | E130314 |
| Environment | RoHS compliant |

Product Data Sheet

DIN 41612 Male 90°, type G,
Part No. 111-40264



Derating Diagram

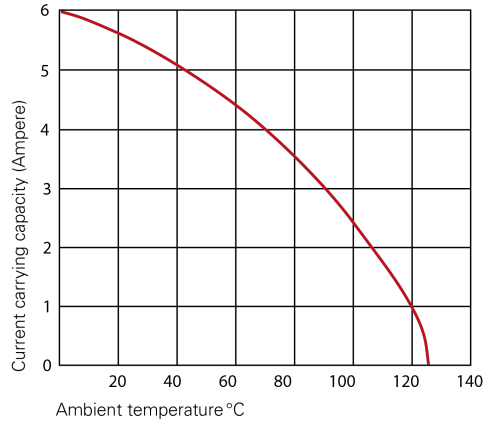

Type D, E, F, G

| | |
|--------|-------|
| 20 °C | 5.6 A |
| 70 °C | 4.0 A |
| 100 °C | 2.5 A |

Product Data Sheet

DIN 41612 Male 90°, type G,
Part No. 111-40264



Options

Board Lock 90°

Suitable for connectors with type B, C, D, E, F, G male connectors and R female connectors

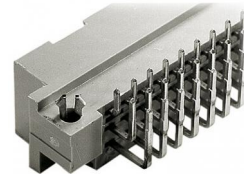
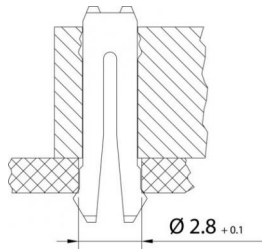

| Type of Insertion | Forces | | | PCB Thickness | Part Number |
|-------------------|----------------|-----------------------------|-------------------------|---------------|-------------|
| | F _m | not soldered F _h | soldered F _h | | |
| Locked | < 30 N | > 10 N | > 20 N | ≤ 1.6 mm | 111-40264C1 |
| Under Tension | < 30 N | > 7.5 N | > 20 N | > 1.6 mm | |

Modifications

Available on request

- Pre-mating and late-mating contacts
- Contact arrangement
- Performance levels I + III or customer-specific
- Special contact length

Drawings

Component data for this product you can request through sales@ept.de