

MC 420-350

Pluggable terminal block

DECA®

Pitch: 3.50mm(0.138inch)



SPECIFICATIONS

			CUL	VDE
負載電壓	Rated Voltage	Bemessungsspannung	AC 300V	AC 300V
負載電流	Rated Current	Bemessungsstrom	10A	10A
電線線徑	Wire Size	Leitergrößen	26~16AWG	0.2~1.5mm ²
塑膠本體	Housing Material	Isolierstofftyp	Polyamide66(UL94V-0)	
押線圈	Cage Clamp	Klemmkörper	Brass, Ni plated	
導電夾片	Contact	Kontakt	Phosphor bronze, Tin plated	
螺絲	Screw Size	Schraubengewinde	M2.0, steel, Ni plated	
操作溫度	Operating Temperature	Umgebungstemperatur	-40°C to + 105°C	
扭力	Torque	Anzugsmoment	3.0 lb-inch	
UL File No.	E167040			

TABLE

Item No.	A(mm)	A(inch)
MC420-35002	7.8	0.307
MC420-35003	11.3	0.445
MC420-35004	14.8	0.583
MC420-35005	18.3	0.720
MC420-35006	21.8	0.858
MC420-35007	25.3	0.996
MC420-35008	28.8	1.134
MC420-35009	32.3	1.272
MC420-35010	35.8	1.409
MC420-35011	39.3	1.547
MC420-35012	42.8	1.685
MC420-35013	46.3	1.823
MC420-35014	49.8	1.961
MC420-35015	53.3	2.098
MC420-35016	56.8	2.236
MC420-35017	60.3	2.374
MC420-35018	63.8	2.512
MC420-35019	67.3	2.650
MC420-35020	70.8	2.787
MC420-35021	74.3	2.925
MC420-35022	77.8	3.063
MC420-35023	81.3	3.201
MC420-35024	84.8	3.339

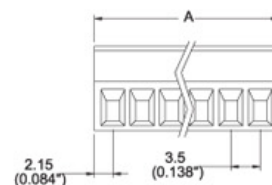
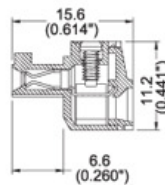
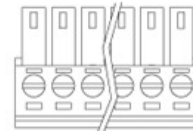

Note:
Screw Plating: Changes are available upon request