

## SPECIFICATION FOR APPROVAL

### Material

Production:	Iron Powder Cores
FUAN.P/N:	KT106-26
AL:	93.0(nH/N <sup>2</sup> )(±10%)
Material:	-26
Coating Color:	Yellow/White
Coating material:	epoxy
Coating Breakdown Voltage:	600V, 0.5mA, 2Sec

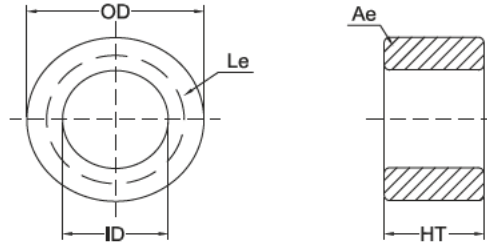

### Physical Characteristics

After Coating			Le(cm)	Ae(cm <sup>2</sup> )	V(cm <sup>3</sup> )	W(cm <sup>3</sup> )	Weight (g) (ref.)	Box Quantity (Pieces)
OD mm	ID mm	Ht mm						
26.9±0.50	14.5±0.50	11.1±0.63	6.490	0.659	4.280	0.967	30.56	504

### Electrical Parameters(Typical) Temperature(25°C±2°C)

Test Item	Test Condition	Value(Typical)	Test Instrument
Inductance	φ0.29mm/10Ts, 10kHz/1V, I=0A (Evenly full windings)	9.3μH(±10%)	CH3302
DC-Bias	φ0.50mm/47Ts,10kHz/1V,L(5.5A)/L(0A)*100%(H=50Oe) (Evenly full windings)	46%(Min.)	WK3255B+WK3265B
Core Loss	100KHz/140Gs	96mW/cm <sup>3</sup> (Max.)	SY 8219
Q	φ0.50mm/47Ts, 200kHz/1V, I=0A (Evenly full windings)	6.0(Min.)	CH3302
Remarks	Set the internal resistance of LCR meter to 100Ω.		

DC Bias Curves(Typical)

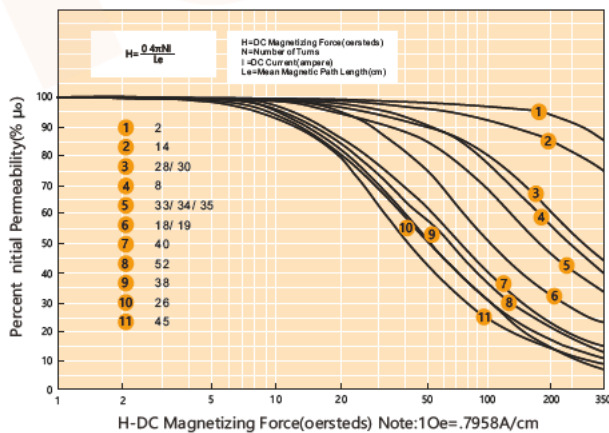

Core Loss Curves(Typical)

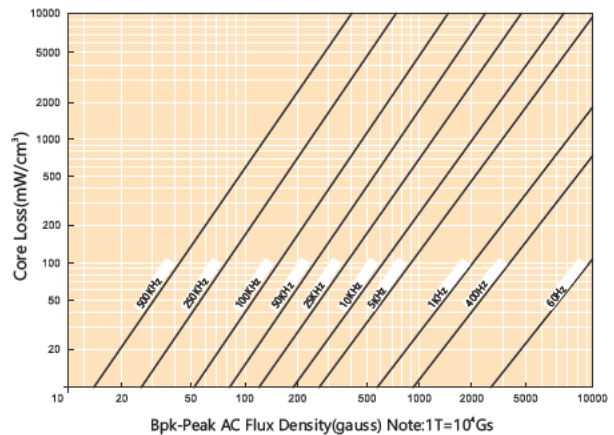

Iron Powder Cores is a magnetic core which use traditional production arts, after the pure powder which content of Fe is more than 99% surface insulation coating and then mixed pressed with organic binder. Because it hasn't been conducted in the high temperature, so it's used temperature is -65°C ~ +125°C. Products including permeability 10ui-100ui, toroid, E type,