

(VI) SMD POWER INDUCTORS

5. SSPS Series (Shielded Type)

Applications

- GPS receiver module.
- Smart Home Systems.
- Other various electronic appliances.

Features

- Available in magnetically shielded.
- SSPS0403 used ceramic base with gold-plating.



Characteristics

- Test Frequency : 1KHz
 - a). SSPS0403: @100KHz 0.1V
- Operating temperature range : -40°C~+125°C.
- Test equipment :
 - L: HP4284A LCR meter or equivalent.
 - DCR: Milli-ohm meter or equivalent.
 - Electrical specifications at 25°C.
- Packing
 - Tape&Reel SPQ:2000pcs/R

Part Number System

SSPS 0403- 220 M

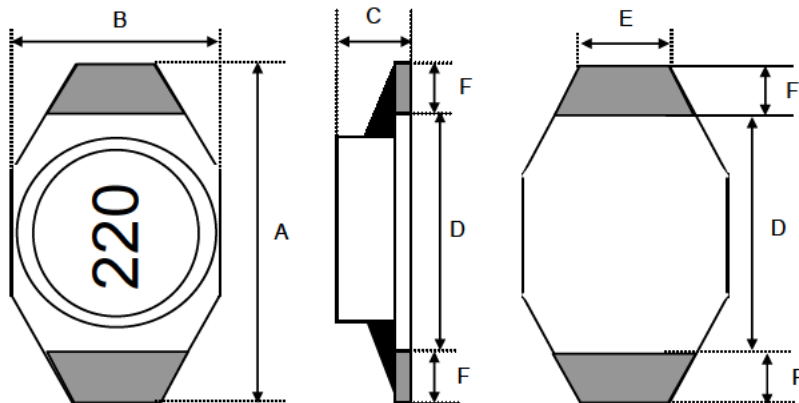
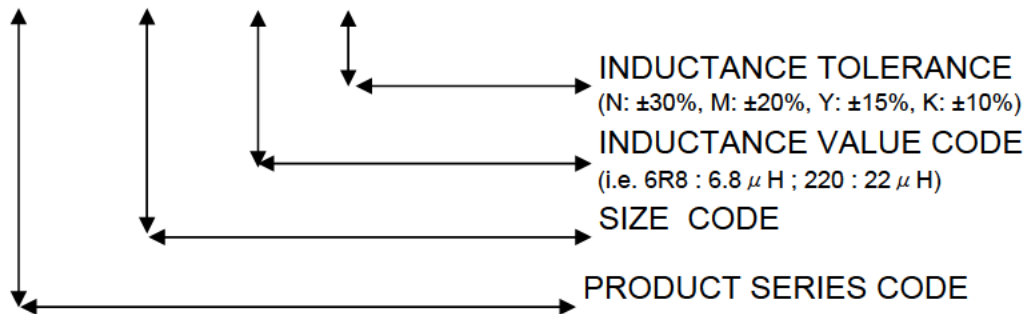

Codes	A (max)	B (max)	C (max)	D	E	F	H	I	J
SSPS0403	6.60	4.45	2.92	4.32	1.27	1.02	3.56	1.40	4.06

(VI) SMD POWER INDUCTORS

5. SSPS Series (Shielded Type)

Electrical Characteristics

Inductance value code	L (μH)	Tol.	DC Resistance (Ω) Max.	Rated DC current (A) Max.	
				I _{rms}	I _{sat}
			0403	0403	0403
1R0	1.0	M	0.040	3.00	1.40
1R5	1.5	M	0.045	2.30	0.93
2R2	2.2	M	0.050	1.80	0.92
3R3	3.3	M	0.055	1.60	0.75
4R7	4.7	M	0.060	1.40	0.58
6R8	6.8	M	0.065	1.20	0.58
100	10	M	0.075	1.00	0.37
150	15	M	0.090	0.80	0.31
220	22	M	0.110	0.70	0.30
330	33	M	0.190	0.60	0.24
470	47	M	0.230	0.50	0.24
680	68	M	0.290	0.40	0.17
101	100	M	0.480	0.30	0.13
151	150	M	0.590	0.26	0.10
221	220	M	0.900	0.22	0.10
331	330	M	1.400	0.20	0.07
471	470	M	1.800	0.19	0.06
681	680	M	2.200	0.18	0.06
102	1000	M	3.400	0.15	0.05
152	1500	M	4.200	0.12	0.04
222	2200	M	8.500	0.10	0.03
332	3300	M	11.000	0.08	0.02
472	4700	M	13.900	0.06	0.02
682	6800	M	25.000	0.04	0.02
103	10000	M	32.800	0.02	0.02

1. Test Frequency: 100 KHz 0.1V

2a). I_{rms}: base on temp. rise 40°C Max.

2b). I_{sat}: base on ΔL/L0A = 10% Typ. (SSPS0403 30%)

3. Operating temperature range : -40°C~+125°C.